

# State of Wyoming Corner Record

(In compliance with the *CORNER PERPETUATION AND FILING ACT*, Wyoming Statutes, 1997, Section 33-29-140, et seq., and the Rules and Regulations of the Board of Registration for Professional Engineers and Professional Land Surveyors)

Reverse side of this form may be used if more space is needed.

Record of original survey and citation of source of historical information (if corner is lost or obliterated). Description of corner monumentation evidence found and/or monument and accessories established to perpetuate the location of this corner. Sketch of relative location of monument, accessories, and reference points with course and distance to adjacent corner(s) (if determined in this survey). Method and rationale for reestablishment of lost or obliterated corner.

Record:-- 1934 – Petersen.  
 N00°-15'E bet. secs. 26 and 27.  
 39.45 The original cor. of secs. 22, 23, 26 and 27, which is a granite stone, 16x12x8 ins., marked with 2 grooves on s. face, firmly set in ground.  
 At point for cor.  
 Set an iron post, 3 ft. long, 2 ins. diam., 27 ins. in the ground for the cor. of secs. 22, 23, 26 and 27 with brass cap mkd.  
 T14N R70W  
 S22 | S23  
 S27 | S26  
 1934  
 Raise a mound of stone 2 ft. base, 1½ ft. high, W. of cor.

Found:-- A 2 ins. galvanized steel pipe (BLM type) with brass cap inscribed as shown.  
 Mound of stone at fence corner.

Set:-- Enlarged mound of stone.

Note:-- Original marked stone appears to be alongside to N. but not identified.

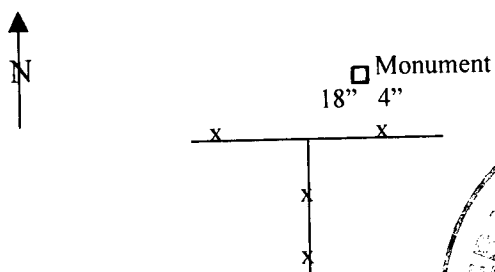

RECORDED 3/24/2008 AT 12:17 PM REC# 496103 BK# 2051 PG# 705  
 DEBRA K. LATHROP, CLERK OF LARAMIE COUNTY, WY PAGE 1 OF 1

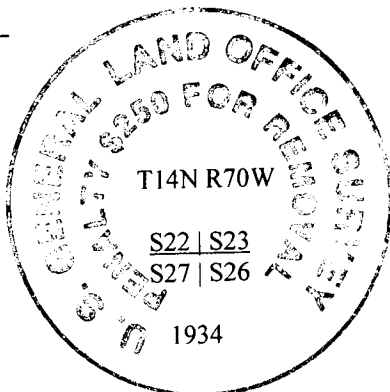

cc: BLM

Date of Field Work: 29 August 1987 Office Reference: Book G1, page 79

### CROSS INDEX DIAGRAM

1	2	3	4	5	6	7	8	9	10	11	12	13	14	15	16	17	18	19	20	21	22	23	24	25	
A																									
B																									
C	6			5					1				3							2					
D																									
E																									
F																									
G	7			8					9				10							11					12
H																									
I																									
J																									
K																									
L	18			17					16				15							14					13
M																									
N																									
O																									
P	19			20					21				22							23					24
Q																									
R																									
S																									
T	30			29					28				27							26					25
U																									
V																									
W																									
X	31			32					33				34							35					36
Y																									
Z																									

Firm/Agency, Address

Surveyor Scherbel, Ltd.  
 P.O. Box 96  
 283 Main Street  
 Big Piney-Marbleton, WY 83113

Telephone Number: 307-276-3347  
 Telefax Number: 307-276-3348

This corner record was prepared by me or under my direction and supervision.

SEAL & SIGNATURE

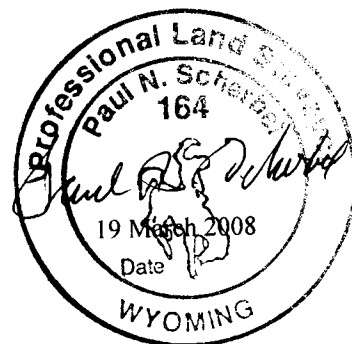

County of LARAMIE

Corner Name: 22/23/26/27 Section: 26 and 27 T 14N R 70W : 6<sup>th</sup> P.M. Cross-Index No.: R-17